

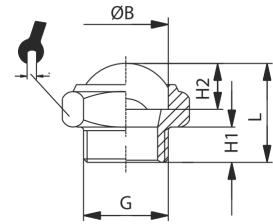

Schalldämpfer flach silencer plain



Betriebstemperatur	-20°C bis +70°C	operating temperature	-20°C up to +70°C
Betriebsdruck	max. 12bar	operating pressure	max. 12bar
Werkstoff	Sinterbronze (36µm) Messing (Ms58) Edelstahl (AISI 304)	material	sintered bronze (36µm) brass (Ms58) stainless steel (AISI 304)
Medium	Druckluft	medium	compressed air

G	ØB [mm]	H ₁ [mm]	L [mm]	H ₂ [mm]	
G1/8	11,0	6,0	16,0	4,0	13,0
G1/4	14,0	8,0	19,0	4,0	16,0
G3/8	17,0	9,0	21,0	4,0	19,0
G1/2	22,0	10,0	23,0	4,0	24,0
G3/4	28,0	10,0	27,0	4,0	30,0
G1	34,0	15,0	29,0	4,0	36,0
M5	6,5	3,5	8,0	3,0	8,0

weitere Optionen und Zubehör auf Anfrage
more options and accessories on request